

INSTRUCTIONS FOR SELF INJECTION

Use the pen only if you have received appropriate training from your healthcare provider and make sure you have a detailed plan for how often you will need to give yourself an injection. Do not reuse the pen.

PRE-FILLED PEN

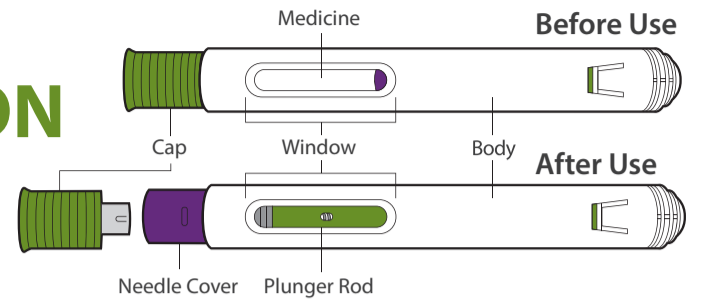

PREPARE FOR REMSIMA INJECTION¹

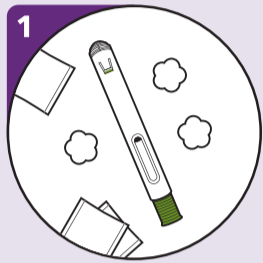

GATHER THE SUPPLIES

- Prepare a clean, flat and well-lit surface such as a table.
- Remove the pen from the carton stored in your refrigerator.

Items needed for injection:

Pen, Alcohol swab, Cotton ball or gauze,* Adhesive bandage,* Sharps disposal container*

* Items not included in the carton.

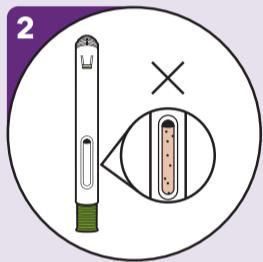

INSPECT THE PEN AND THE MEDICINE

- Do NOT use the pen if
 - it has been cracked or is visibly damaged
 - the expiration date has passed.
- Do NOT use the pen if the liquid is:
 - not clear or contains particles
 - not colourless or pale brown or contains particles in it.
- Do not shake the pen at any time.

It is normal for air bubbles to be present inside the liquid.



WAIT 30 MINUTES

- Leave the pen at room temperature for 30 minutes to allow it to naturally warm up.
- Do not warm the pen using heat sources.

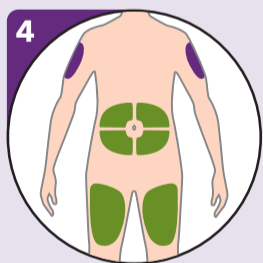

CHOOSE AN INJECTION SITE

- Select an injection site.
- Rotate the injection site each time you give an injection.
- Each new injection site should be at least 3cm away from the previous site.

Possible injection sites:

- ✓ The front of the thighs
- ✓ The abdomen, except for the 5cm around the belly button (navel)
- ✓ The outer area of the upper arms, ONLY if given by a caregiver

■ Self-injection and Caregiver
■ Caregiver ONLY

* Do not inject into the skin that is within 5cm of your belly button (navel) or is tender, damaged, bruised, or scarred.



WASH YOUR HANDS AND CLEAN THE INJECTION SITE

- Wash your hands with soap and water and dry them fully.
- Clean the injection site with an alcohol swab.
- Let the skin dry before injecting.

* Do not blow or touch the injection site again before giving the injection.

GIVE THE INJECTION¹

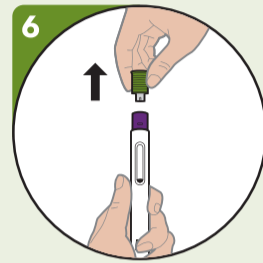

REMOVE THE CAP

- Pull the olive green cap straight off and set it aside.
- * Do not touch the needle cover.

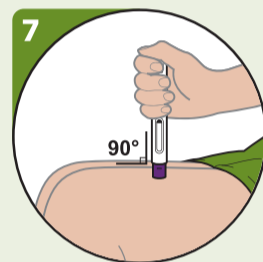

PLACE THE PEN

- Hold the pen so that you can see the window.
- Without pinching or stretching the skin, place the pen over the injection site at a 90-degree angle.

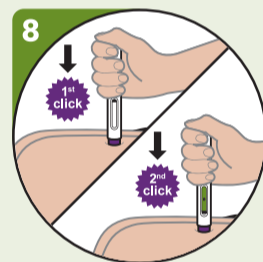

START THE INJECTION

- Press the pen firmly against the skin. When the injection starts you will hear the 1st loud "click" and the olive green plunger rod will begin to fill the window.
- Keep holding the pen and listen for the 2nd loud "click".
- After you hear the 2nd loud "click", continue to hold the pen and count slowly to at least five.

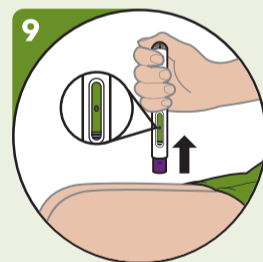

REMOVE THE PEN

- Check and confirm that the window is filled with olive green plunger completely.
- Lift the pen from the injection site.

Gently press a cotton ball or gauze over the injection site.

- * Apply an adhesive bandage if needed.
- * Do not rub the injection site.
- * If the olive green rod is not filling the window fully, you did not receive your full dose. Do not reuse the pen in this case. Call your healthcare provider immediately.

AFTER THE INJECTION



DISPOSE OF THE PEN

- Put the used pen in an approved sharps disposal container immediately after use.

If you do not have an approved sharps disposal container, you may use a household container that is:

- ✓ Made of heavy-duty plastic
- ✓ Able to close with a tight fitting, puncture resistant-lid, without sharps being able to come out
- ✓ Upright and stable during use
- ✓ Leak-resistant
- ✓ Properly labelled to warn of hazardous waste inside the container

* When your container is almost full, dispose in accordance with local requirements.

* Do not recap the pen.

* Keep the pen and sharps disposal container out of reach of children.

INSTRUCTIONS FOR SELF INJECTION

Use the syringe only if you have received appropriate training from your healthcare provider and make sure you have a detailed plan for how often you will need to give an injection. Do not reuse the syringe.

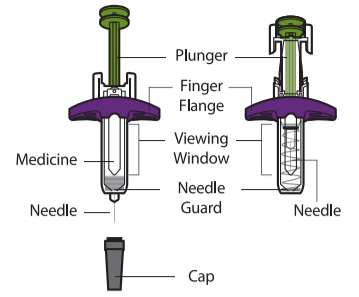

Before Use After Use

PRE-FILLED SYRINGE

WITH NEEDLE GUARD

PREPARE FOR REMSIMA INJECTION¹



GATHER THE SUPPLIES

- Prepare a clean, flat and well-lit surface such as a table.
- Remove the syringe from the carton stored in your refrigerator.

Items needed for injection:

Syringe, Alcohol swab, Cotton ball or gauze,* Adhesive bandage,* Sharps disposal container*

* Items not included in the carton.

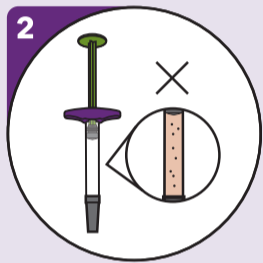

INSPECT THE SYRINGE AND THE MEDICINE

- Do NOT use the syringe if:
 - it has been cracked or is visibly damaged
 - the expiration date has passed.
- Do NOT use the syringe if the liquid is:
 - not clear or contains particles
 - not colourless or pale brown or contains particles in it.
- Do not shake the syringe at any time.

It is normal for air bubbles to be present inside the liquid.



WAIT 30 MINUTES

- Leave the syringe at room temperature for 30 minutes to allow it to naturally warm up.
- Do not warm the syringe using heat sources.

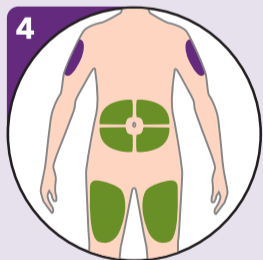

CHOOSE AN INJECTION SITE

- Select an injection site.
- Rotate the injection site each time you give an injection.
- Each new injection site should be at least 3cm away from the previous site.

Possible injection sites:

- ✓ The front of the thighs
- ✓ The abdomen, except for the 5cm around the belly button (navel)
- ✓ The outer area of the upper arms, ONLY if given by a caregiver

* Do not inject into the skin that is within 5cm of your belly button (navel) or is tender, damaged, bruised, or scarred.



WASH YOUR HANDS AND CLEAN THE INJECTION SITE

- Wash your hands with soap and water and dry them fully.
- Clean the injection site with an alcohol swab.
- Let the skin dry before injecting.

* Do not blow or touch the injection site again before giving the injection.

GIVE THE INJECTION¹

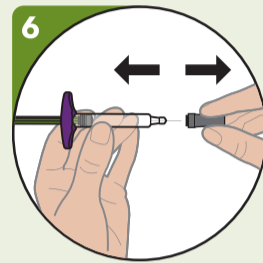

REMOVE THE CAP

- Pull the cap straight off and set it aside.

* Do not touch the needle.

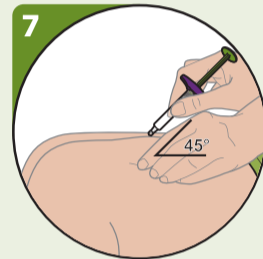

INSERT THE SYRINGE INTO THE INJECTION SITE

- Hold the syringe by its body in one hand between your thumb and index finger.
- Using your other hand gently pinch a fold of cleaned skin.
- With a quick and 'dart-like' motion, insert the needle completely into the fold of skin at a 45-degree angle.

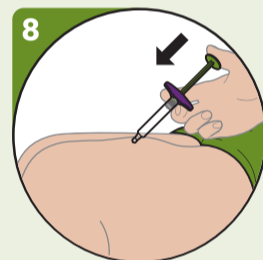

GIVE THE INJECTION

- After the needle is inserted, let go of the pinched skin.
- Push the plunger down slowly and as far as it will go until the syringe is empty.

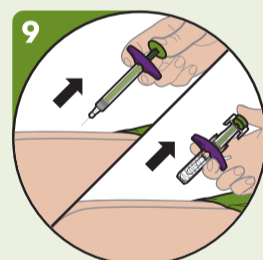

REMOVE THE Syringe

- After the syringe is empty, slowly lift your thumb from the plunger until the needle is completely covered by the automatic needle guard.

Gently press a cotton ball or gauze over the injection site and hold for 10 seconds. Apply an adhesive bandage if needed. Do not rub the injection site.

AFTER THE INJECTION



DISPOSE OF THE Syringe

- Put the used syringe in an approved sharps disposal container immediately after use.

If you do not have an approved sharps disposal container, you may use a household container that is:

- ✓ Made of heavy-duty plastic
- ✓ Able to close with a tight fitting, puncture resistant-lid, without sharps being able to come out
- ✓ Upright and stable during use
- ✓ Leak-resistant
- ✓ Properly labelled to warn of hazardous waste inside the container

* When your container is almost full, dispose in accordance with local requirements.

* Do not recap the syringe.

* Keep the syringe and sharps disposal container out of reach of children.